

12

11

# Typ 7

10

UK.-Sturz = 2.62 m  
BRH 1.00 m

UK.-Sturz = 2.62 m  
BRH 1.00 m

RR

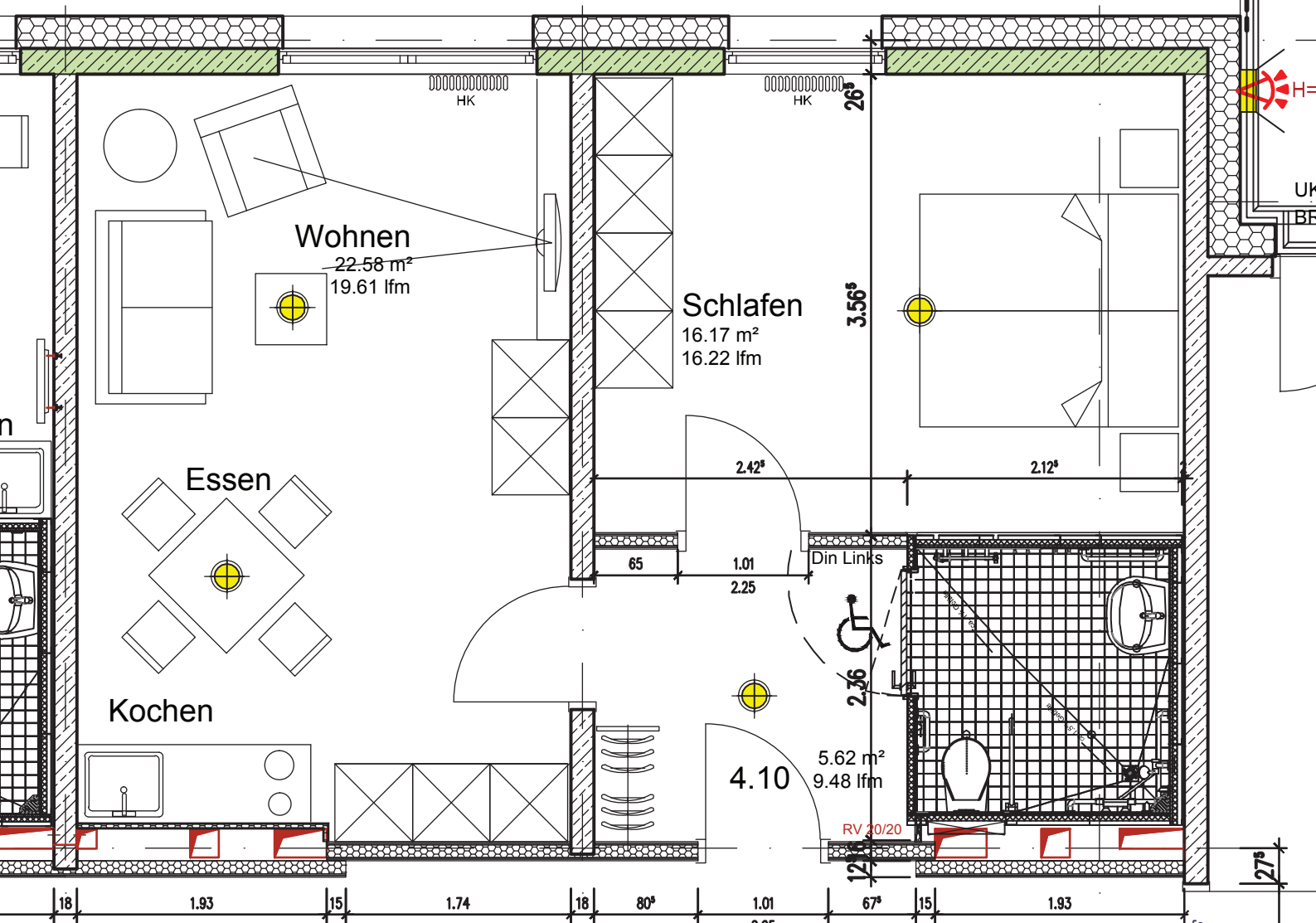

Wohnen  
22.58 m<sup>2</sup>  
19.61 lfm

Schlafen  
16.17 m<sup>2</sup>  
16.22 lfm

Essen

Kochen

Din Links

4.10  
5.62 m<sup>2</sup>  
9.48 lfm

RV 30/20

27<sup>8</sup>

18 | 1.93 | 15 | 1.74 | 18 | 80<sup>8</sup> | 1.01 | 67<sup>8</sup> | 15 | 1.93

HK

HK

26<sup>8</sup>

3.56<sup>8</sup>

2.42<sup>8</sup>

2.12<sup>8</sup>

65

1.01

2.25

2.36

12<sup>8</sup>